

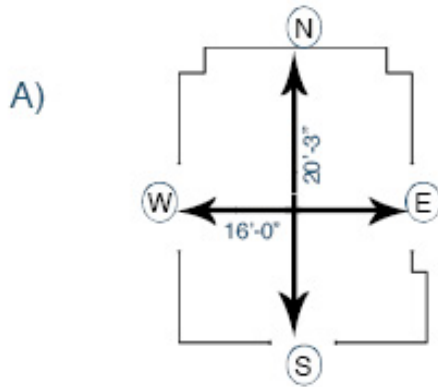

# WINDSOR SMITH ROOM IN A BOX™

## HOW TO MEASURE YOUR ROOM



### Floorplan

1. Draw a floorplan of your room. Label each wall North, East, South, and West as this will help us keep things clear.

Now Measure the length of the room down the center, and do the same for the width of the room. Indicate the measurements on your floorplan as shown. (Example A)

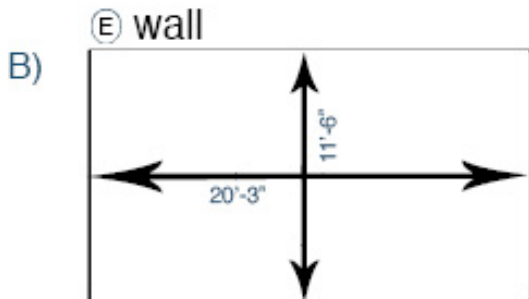

### Wall Drawings

2. Now measure each individual wall in feet and inches. Draw a diagram of the face of the wall and indicate which wall it is - North, East, South or West. Measure the width and height. Record each measurement. (Example B)

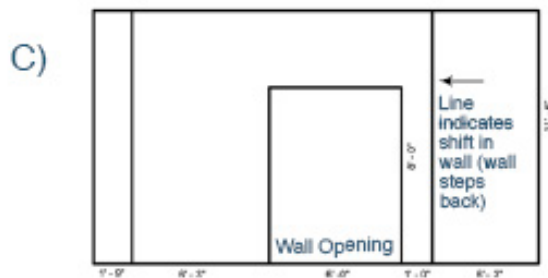

3. Next you should draw in the placement of all the wall features such as doors, windows and built-ins. Measure each section and indicate their placement on the wall. (Example C)

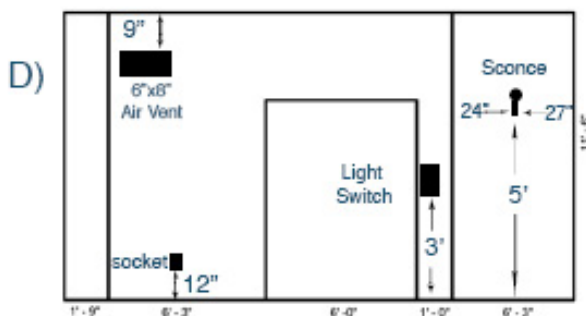

4. Draw in some key details. Locate and indicate sconces, electrical sockets, light switches, air vents, and wainscoting. Measure from the floor to the base of the fixture. Then measure the fixture.

Note: Door and window frames, base and crown moldings do not need to be measured. Our experience along with your photographs will give us the information we need to proceed with the design of your room. (Example D)

Please repeat steps 2,3 and 4 for all four walls.



# WINDSOR SMITH ROOM IN A BOX™

## HOW TO MEASURE YOUR ROOM

E)

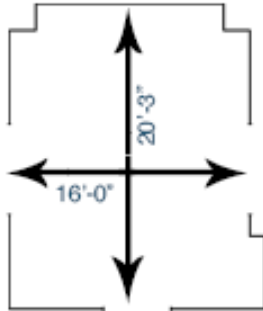

Length: 16'-0" = 192"  
 Width: 20'-3" = 243"  
 $192 \times 243 = 46656$ "  
 $46656 / 144 = 324$  sq. ft

### Calculating your square footage

5. For a square or rectangular area, take the measurements of the length and width of the room that you rerecorded earlier. Multiply the length by the width. Convert measurements of feet and inches into inches before you multiply. After you have found the area in square inches, you can divide this number by 144 to get the square footage. You now have the square footage. (Example E)

F)

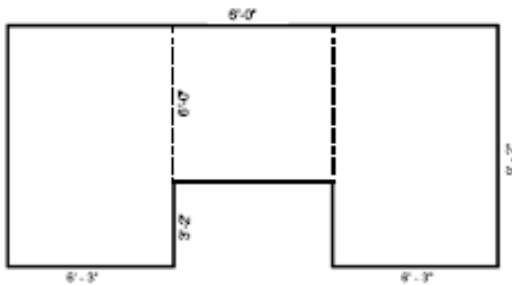

$75" \times 110" = 8250$        $72" \times 72" = 5184$        $75" \times 110" = 8250$

$8250 + 5184 + 8250 = 17580 / 144 = 150.58 = 151$  sq. ft.

6. If you have a complex shaped room, divide the room into sections of simple squares and rectangles. Calculate the separate areas and then add all of them together. (Example F)

### Tip

Double-check your measurements before multiplying.